

# DVD Kitchen Radio with LCD-TV

AJL700

## Quick Start Guide

- 1** Preparation
- 2** Connect it
- 3** Mount it
- 4** Use it



This **Guide** shows you:

- basic installation setup
- how to install your unit
- how to play a DVD
- how you can watch TV on the unit

For detailed operation of all the features, please also read the **User manual**.

# PHILIPS

## What's in the box

<b>DVD Kitchen Radio with LCD-TV</b> 	<b>Remote control with 2xAA batteries</b> 	<b>4 x spacers</b> 
<b>Quick start guide</b> 	<b>Mounting template</b> 	<b>User manual</b> 
<b>8 x screws</b> 	<b>12V DC adapter with bracket</b> 	<b>AM antenna</b> 
<b>FM antenna</b> 	<b>L-shape adapter antenna</b> 	

## What else you'll need

These tools (not included) will help you mount the unit as described in part 3 Mount it, and on the template.

<b>Electric drill</b> 	<b>Tape measure</b> 	<b>Scissors</b> 
<b>Sellotape</b> 	<b>Screwdriver</b> 	<b>Safety goggles</b> 

## 1 Preparation

For best performance, install the unit as far as possible from sources of noise and interference (e.g. fridges, microwaves, fluorescent lamps)

- a Find a mounting location near a wall outlet.
- b Use the mounting template to test the design and thickness your kitchen cabinet bottom.
- c Decide whether you want to connect the unit with other audio/ visual equipment. ( See **2B** below)

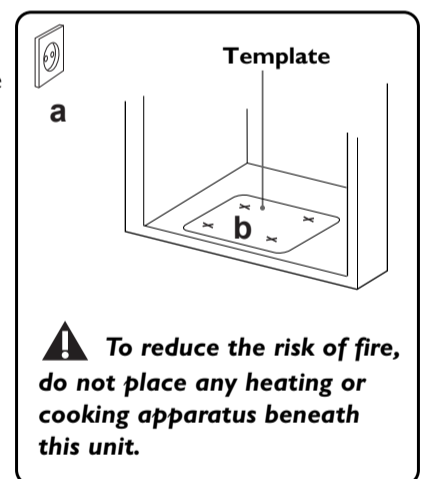

## 2 Connect it

**A** Connect the following supplied accessories to the respective jacks on the rear of the unit :

- **12V DC** power adapter
- **For radio reception**, connect the **AM** and **FM** antennas.

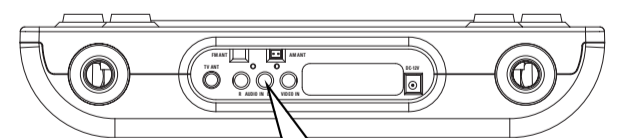

**B** **Other connections (cables not included)**

- For TV reception on the unit, plug the supplied L-shaped adapter into TV ANT as shown. Then connect a TV antenna/CATV cable (not supplied)..
- For use with VCR or other audio/video appliances, connect the composite cable and match the colors of the cinches (**AUDIO IN L/R**, **VIDEO IN**) on the unit.

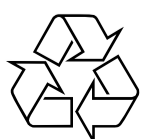
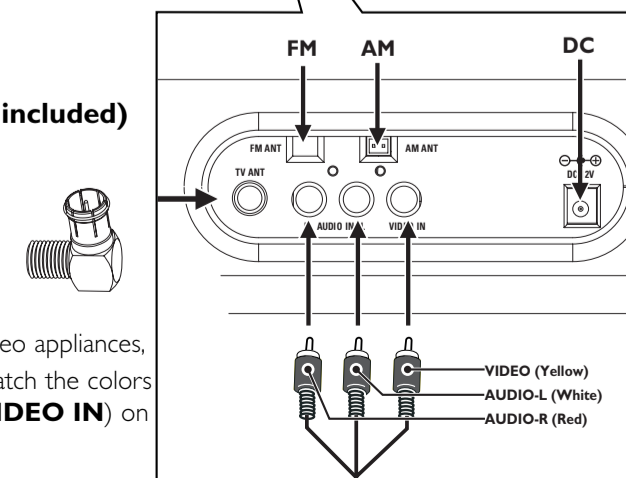

### 3 Mount it

Ask a friend to help out. An extra hand to hold the unit makes mounting easier and quicker.

#### A

- Cut the template to fit inside the cabinet.
- Align the template border marked **"FRONT"** along the front edge of your cabinet.
- Use adhesive tape to fix the template.
- Drill 1/4 inch holes, as marked **X** on the template.
- Remove the template when you finish drilling.

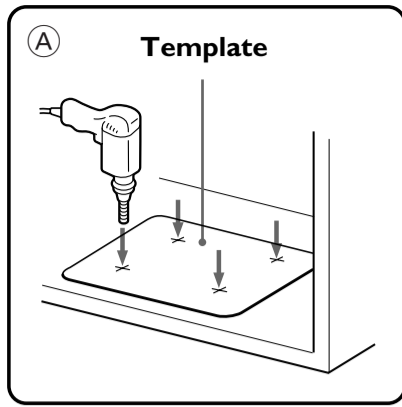

#### Tip

- Clean the bottom of the cabinet surface and also empty your cabinet before mounting.
- Place the unit in a clean, safe place when drilling to avoid wood shavings dropping into the ventilation slots.
- Use a nail to start each drill hole.
- Drill from the bottom upwards if you do not have enough room inside the cabinet.
- Hold your drill firmly at 90° with the cabinet bottom and drill holes at low speed.
- Clear wood shavings.

#### B

##### Using the spacers

On the spacers, there are 4 pairs of notch length options. Depending on the thickness of your cabinet bottom (with/ without an overhang), these notch lengths correspond to the 4 notch height in the space holders, and allow you to adjust to the best height to help you mount the unit.

- Measure the height of the cabinet bottom and/overhang.
- Turn the spacer counterclockwise to determine which of the 4 heights is most suitable: **Low** • • **High**. Align to the arrow indication.
- Insert the spacers accordingly.

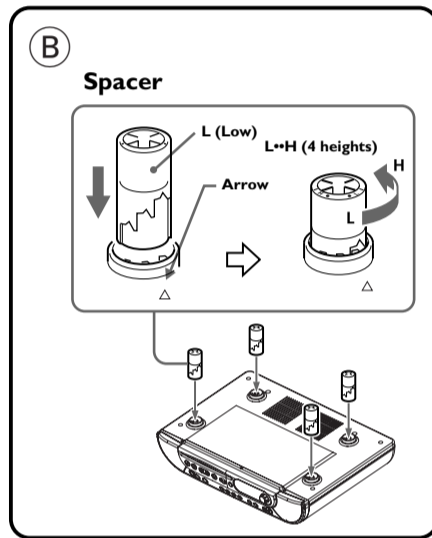

#### C

- **Manually** fasten the 4 long screws down into the spacer holder holes to mount your set. Start screwing at opposite corners of the unit for better support.

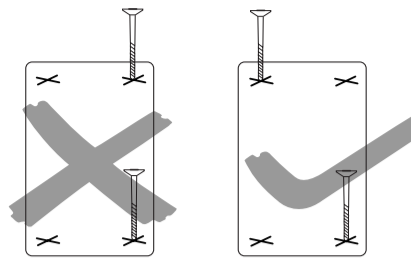

#### Tip

**!** To prevent damage to your set, do not use an electric drill to secure screws when mounting!

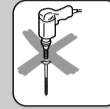

- If the overhang is more than 1 1/4 inch, use longer screws (not included).

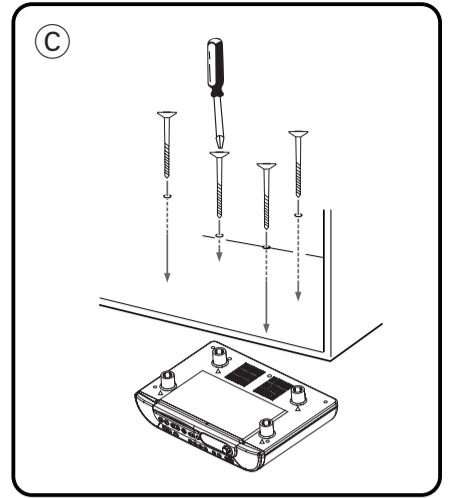

#### D

##### Using the adapter bracket

Find a suitable place to mount the adaptor bracket.

- 1 Use 2 small screws (supplied) to mount the bracket.
- 2 Insert the adapter into the bracket as shown.
- 3 Use the adapter bracket to wrap and secure the power cord so that excess cord does not hang down.

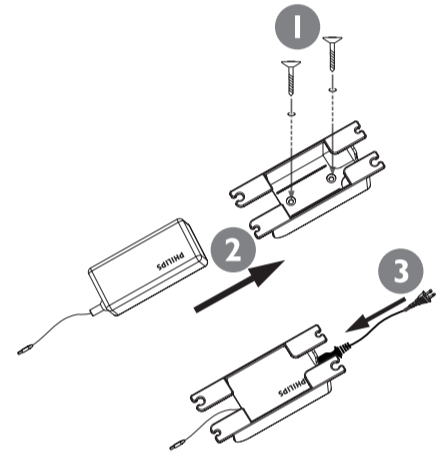
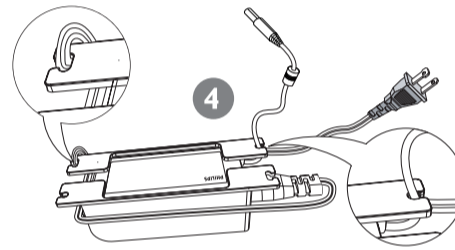

### 4 Use it

For full details, please read and follow the instructions inside the **User manual**.

#### A

##### Power supply

- Connect the power plug to the wall outlet.
- Press **POWER** (or **STANDBY.ON**) to switch on.

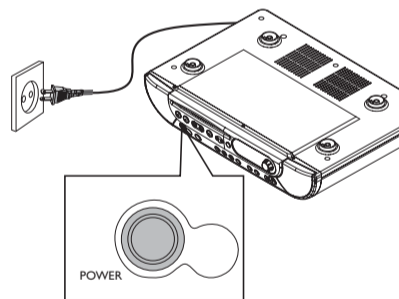

#### B

##### Using the TV screen

- 1 Press **PUSH** at the bottom the set to release the TV panel.
- 2 Pull down the panel (maximum 115°).
- 3 Turn around the panel to find the screen.
- 4 Adjust the screen to a suitable angle (maximum 270°).

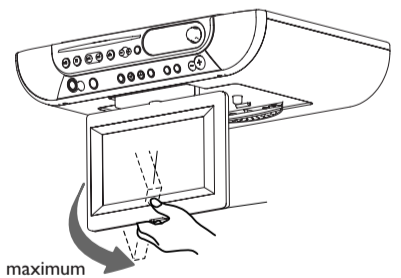
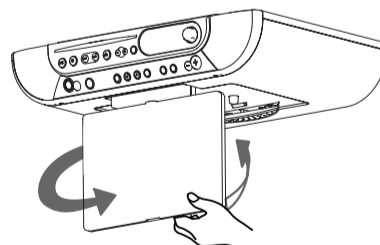
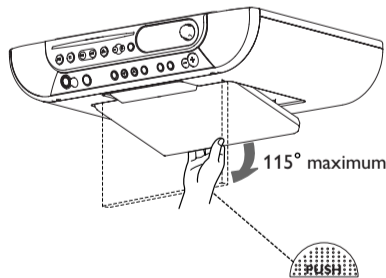

#### Tip

- Swivel with care to avoid breakage. Screen rotates a maximum 270° only.

#### C

##### How to play a DVD /CD

- Select **DVD** source.
- Insert a DVD/CD.
- Press **PLAY/PAUSE** to start disc playback.

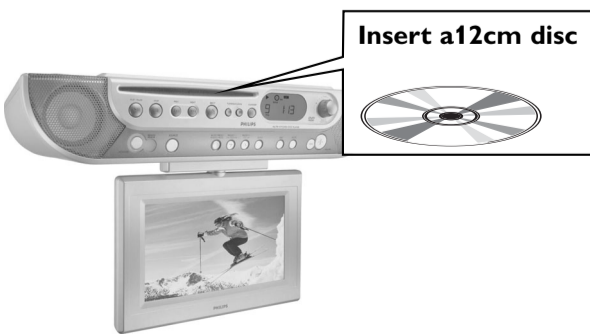

#### D

##### How to watch TV on the unit

- 1 Press **TV** once or more to select TV or CATV mode.
- 2 In CATV, press **ENTER** on the remote control selects HRC, IRC, STD or AUTO mode.
- 3 The first time you use the TV, press and hold **AUTO PROG /RADIO PROG** on the set until the channel number starts running.
- Available channels are programmed.
- 4 Use the **Numeric Keypad (0-9)** on the remote control to select the channel number directly.



#### E

##### Improve radio reception

**Position the antenna as far as possible from a TV, VCR or radiation source.**

##### FM:

**Keep the FM antenna as horizontal as possible. Fix the antenna's end to the wall.**

##### AM:

**Position vertically. If necessary, use 2 small screws (supplied) to fix the antenna to a flat, hard and stable place.**

